

**Hi-Arc™ Deluxe Single-Lever Kitchen Faucet  
LK4324FWH (White), LK4324FAL (Almond),  
LK4324FBK (Black), LK4324FD (Polished Brass)**



**SPECIFICATIONS**

**GENERAL**

Single-lever Hi-Arc™ kitchen faucet with circular brass base finished in a polished brass or colored epoxy finish. Tubular brass Hi-Arc contemporary style 10" swing spout with restricted flow aerator also finished in a polished brass or colored epoxy finish. Removable cartridge. Temperature and flow controlled by one movement of the single-lever handle. All operating parts are replaceable from above deck. Colored retractable spray with hose and a polished brass or colored epoxy finish spray nest. 3/8" O.D. copper tube connections with 1/2" I.P. connections. Requires three faucet holes. Ship. Wt. 6 lbs.

**MAXIMUM FLOW RATE**

2.5 GPM/9.5 L/min AT 80 P.S.I.G.  
2.2 GPM/8.3 L/min AT 60 P.S.I.G.

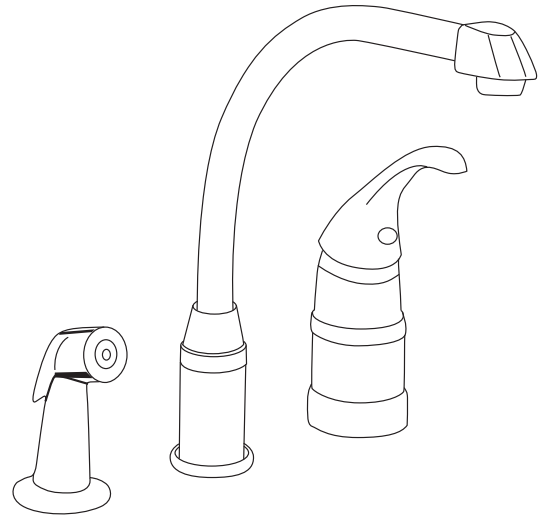
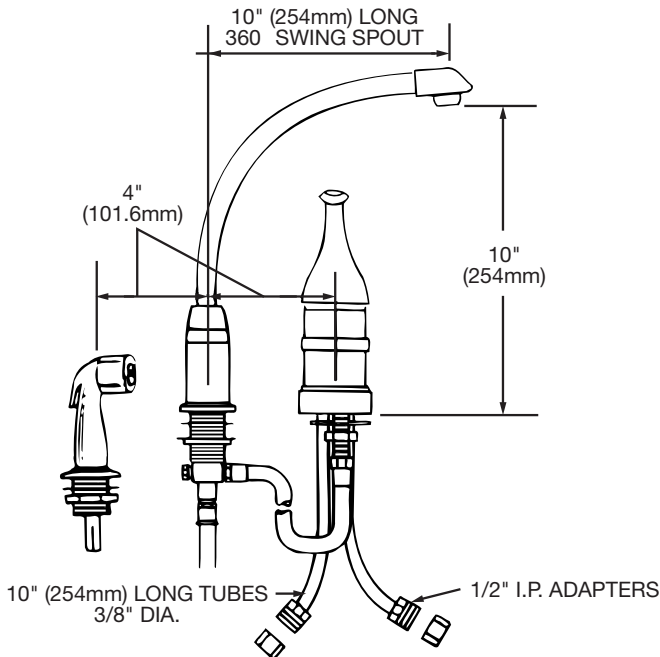

This faucet is ADA compliant.



This faucet is classified by Underwriters Laboratories Inc. to **ANSI/NSF61** for residential use.

**CARTRIDGE**

Maintenance-free, drip-free washerless cartridge that is completely self-contained and easily removable.

A simple cam-activated movement of the diaphragm controls the flow of water with a feather-lite touch.

No springs. No wearing action. And no moving parts exposed to water.

U.S. Patent #4,357,957

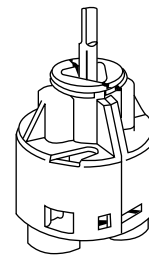

**ELKAY FAUCET/WATER DISPENSERS LIMITED WARRANTY**

Elkay warrants its faucet and water dispensers to be free of defects in workmanship and material for a period of one year from the date of purchase. Replacement parts are available from Elkay for a nominal charge. Upon return of a defective part to Elkay during the warranty period with written notice of the claimed defect, Elkay will refund the replacement charge.

**WASTE FITTINGS AND ACCESSORIES ARE NOT WARRANTED; OTHER WARRANTY CONDITIONS:**

Our warranty does not cover product failure caused by abusive treatment, misuse, or damage due to handling or faulty installations. This warranty is extended only to the original consumer purchaser of the product. This warranty does not cover shipping costs, labor costs, or any other charges for such items as installation or replacement of the sink, diagnosis or replacement of any faucet or component part, or any other expense or loss.

ALL INCIDENTAL OR CONSEQUENTIAL DAMAGES ARE SPECIFICALLY EXCLUDED. NO ADDITIONAL WARRANTIES, EXPRESS OR IMPLIED, ARE GIVEN. ANY IMPLIED WARRANTY, INCLUDING ONE OF MERCHANTABILITY OR FITNESS FOR A PARTICULAR PURPOSE, IS LIMITED TO THE DURATION OF THIS WRITTEN WARRANTY.

Some states do not allow the exclusion or limitation of incidental or consequential damages or limitations on how long an implied warranty lasts, so the above limitations or exclusions may not apply to you.

This warranty gives you specific legal rights, and you may also have other rights which vary from state to state.

**TO OBTAIN SERVICE UNDER WARRANTY**

1. Write to: Elkay Manufacturing Company  
Attention: Consumer Service  
2222 Camden Court  
Oak Brook, Illinois 60523
2. Include a letter containing the following information:
  - a. Date of purchase and installation
  - b. Description of nature of defect
  - c. Model number or description of model and/or component part if possible.

**PARTS LIST**

Key	LK4324FWH WHITE	LK4324FBK BLACK	LK4324FAL ALMOND	LK4324FD BRASS
1	A51357WH	A51357BK	A51357AL	A51357D
2	A54567 INCL:	A54566 INCL:	A54565 INCL:	A54574 INCL:
	A54544	A54543	A54579	A52656D
	A52657C (2)	A52657C (2)	A52657C (2)	A52657C (2)
	A51861	A51861	A51861	A51861
	A54738S	A54502S	A54738S	A54502S
	A51357WH	A51357BK	A51357AL	A51357D
3	A54544	A54543	A54579	A52656D
4	A54738S	A54502S	A54738S	A54502S
5	A52657C (2)	A52657C (2)	A52657C (2)	A52657C (2)
6	A51861	A51861	A51861	A51861
7	A51981	A51981	A51981	A51981
8	A54570	A54569	A54568	A52650D
9	A54737	A54520	A54737	A54520
10	A54573	A54572	A54571	A52546D
11	A53245	A53245	A53245	A53245
12	A51336	A51336	A51336	A51336
13	A52740	A52740	A52740	A52740
14	A52765R	A52765R	A52765R	A52765R
15	A54586	A54587	A54585	A54584
16	LK3717	LK3717	LK3717	LK3717
17	A54354WH	A54354BK	A54354AL	A51493D
18	A52811	A52811	A52811	A52811
19	A52373	A52373	A52373	A52373
20	A54377	A54378	A54376	A54580
21	A54337	A54338	A54336	A53920D
22	A54533	A54532	A54534	A52364D
23	A54550	A54549	A54548	A54535D
24	A52399R INCL:	A52399R INCL:	A52399R INCL:	A52399R INCL:
	A53226R	A53226R	A53226R	A53226R
25	A53226R	A53226R	A53226R	A53226R
26	A53048	A53048	A53048	A53048
27	A52387	A52387	A52387	A52387
28	A54578	A54576	A54575	A54577
29	A52801	A52801	A52801	A52801

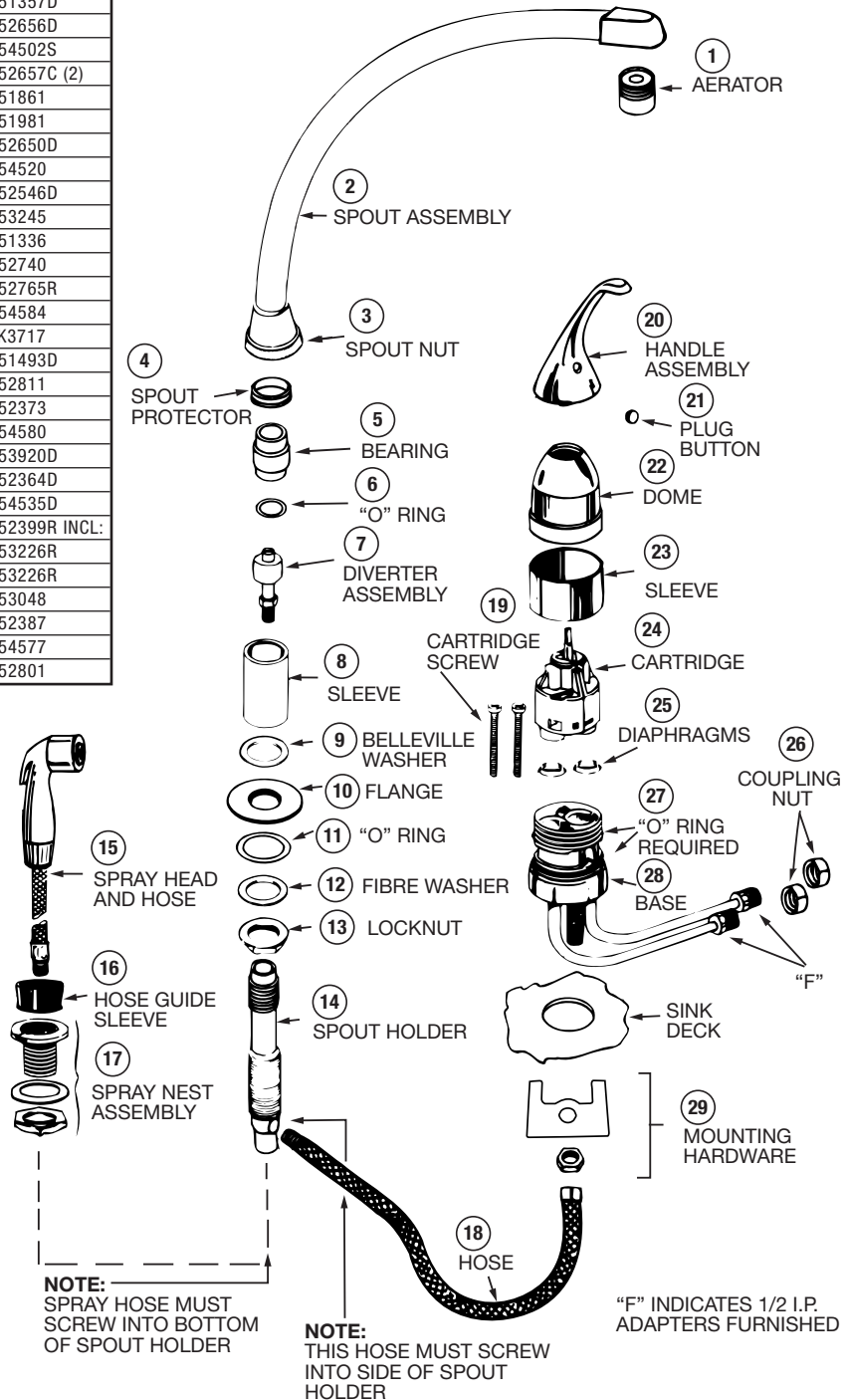

**NOTE:**  
 SPRAY HOSE MUST  
 SCREW INTO BOTTOM  
 OF SPOUT HOLDER

**NOTE:**  
 THIS HOSE MUST SCREW  
 INTO SIDE OF SPOUT  
 HOLDER

"F" INDICATES 1/2 I.P.  
 ADAPTERS FURNISHED